

- 1
- 2
- 3
- 4
- 5
- 6
- 7
- 8
- 9
- 10
- 11
- 12
- 13
- 14
- 15
- 16
- 17
- 18

## MATERIAL

Aluminium, matte finish.  
AISI 304 stainless steel screws and nuts.

## STANDARD EXECUTIONS

Surface finish index:  
- **BL**: natural colour.  
- **SW**: epoxy resin coating resistant to UV rays, RAL 9005 black colour.

## FEATURES AND APPLICATIONS

The assembly hole of GN 145 connecting clamps allows an excellent match with tubes GN 990 (see page 1368).  
The clamping screw d3 may be replaced by clamping kit GN 911 (see page 1372).

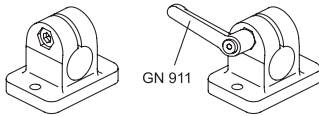

Conversion Table	
1 mm = 0.039 inch	
d1	
mm	inch
10	0.39
12	0.47
14	0.55
15	0.59
16	0.63
18	0.71

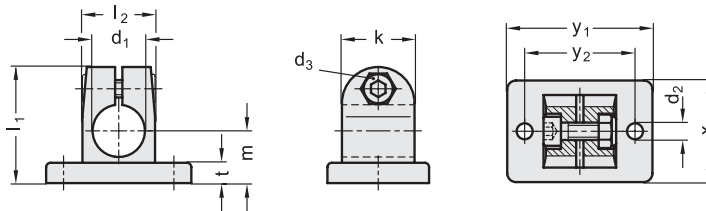

## METRIC

Code BL	Code SW	Description	d1	d2	d3	k	l1	l2	m	t	x	y1	y2	d3 Clamping kit	△
GN.45411	GN.45416	GN 145-B10-2-*	10	5.5	M6	25	40	25	18	7	35	50	38	GN 911-M6-22	71
GN.45431	GN.45436	GN 145-B12-2-*	12	5.5	M6	25	40	25	18	7	35	50	38	GN 911-M6-22	69
GN.45451	GN.45456	GN 145-B14-2-*	14	5.5	M6	25	40	25	18	7	35	50	38	GN 911-M6-22	67
GN.45471	GN.45476	GN 145-B15-2-*	15	5.5	M6	25	40	25	18	7	35	50	38	GN 911-M6-22	67
GN.45491	GN.45496	GN 145-B16-2-*	16	5.5	M6	25	40	25	18	7	35	50	38	GN 911-M6-22	64
GN.45511	GN.45516	GN 145-B18-2-*	18	5.5	M6	25	40	25	18	7	35	50	38	GN 911-M6-22	60